

2020-04-16

**REQUEST FOR TENDER
AFRICA PAVILION – WASHROOM UPGRADES
RFT No.: TZC T 26-2020-03**

ADDENDUM 5

This addendum shall be incorporated into, and form part of RFT No.: TZC T 26-2020-03 and take precedence over all requirements of the previously issued bid documents including plans. This addendum must be signed by the bidder (signing officer) in the appropriate space and must be attached to the form for submission by the bidder. This addendum consists of TWO (2) page(s) and the documents listed below.

1. SUBMISSION DEADLINE:

Revised Submission Deadline: Friday, 2020-04-24 at 12:00 p.m. local time

2. DELETE DRAWINGS:

SHEET NUMBER	SHEET NAME	ISSUE DATE
A203	REFLECTED CEILING PLAN	2020-03-13
E-7.1	ELECTRICAL SINGLE LINE DIAGRAM	2020-04-03

REPLACE WITH DRAWINGS:

SHEET NUMBER	SHEET NAME	ISSUE DATE
A203	REFLECTED CEILING PLAN	2020-04-14
E-7.1	ELECTRICAL SINGLE LINE DIAGRAM	2020-04-15

3. QUESTION:

My electrician has noted that it looks like there is nothing available from supplier to retrofit a new switch into the existing MCC panel as noted on the drawings. They are suggesting an external disconnect switch, or something similar.

RESPONSE:

The new bucket c/w breaker, as specified is required. As detailed on drawing No. E-7.1 the electrical contractor must engage a CSA approved panel manufacturer to field retrofit the bucket c/w breaker into the existing MCC. Please refer to addendum E-02 for additional requirements.

Receipt of the addendum shall be acknowledged as part of your submission.

The Board of Management of the Toronto Zoo reserves the right to reject any or all quotations or to accept any quotation, should it deem such action to be in its interests.

If you have any queries regarding this matter, please contact Mr. Peter Vasilopoulos, Supervisor, Purchasing & Supply, at 416-392-5916.

Yours truly,

Peter Vasilopoulos

Supervisor, Purchasing & Supply

I/we hereby acknowledge receipt of this addendum and make allowance in my bid.

Signed (Must be Signing Officer of Firm)

Name of Firm

Date

2020-04-15

**Request for Tenders for
 AFRICA PAVILION – WASHROOM UPGRADES
 RFT No.: TZC T 26-2020-03
 ADDENDUM 5**

This addendum shall be incorporated into, and form part of RFT No.: TZC T 26-2020-03 and take precedence over all requirements of the previously issued bid documents including plans. This addendum must be signed by the bidder (signing officer) in the appropriate space and must be attached to the form for submission by the bidder. This addendum consists of TWO (2) page(s) and the documents listed below.

1. DELETE DRAWINGS:

SHEET NUMBER	SHEET NAME	ISSUE DATE
A203	REFLECTED CEILING PLAN	2020-03-13

REPLACE WITH DRAWINGS:

SHEET NUMBER	SHEET NAME	ISSUE DATE
A203	REFLECTED CEILING PLAN	2020-04-14

2. QUESTION:

My electrician has noted that it looks like there is nothing available from supplier to retrofit a new switch into the existing MCC panel as noted on the drawings. They are suggesting an external disconnect switch, or something similar.

RESPONSE:

There is no standard retrofit kit available. As detailed on drawing No. E-7.1 the electrical contractor must engage Siemens field services group or another manufacturer to field retrofit the breaker into the existing MCC and to recertify the panel bus.

PROVIDE NEW CIRCUIT BREAKER BUCKET C/W BREAKER INDICATED.
 PROVIDE MOUNTING HARDWARE TO ACCOMMODATE EXISTING PANEL BUS.
 PROVIDE LUGS TO ACCOMMODATE WIRE SIZE INDICATED.
 PROVIDE THE SERVICE OF SIEMENS FIELD SERVICES GROUP TO EXTEND, REWORK, MODIFY AND RECERTIFY EXISTING PANEL BUS AS REQUIRED TO FACILITATE INSTALLATION OF BREAKER PROVIDED AS PART OF THIS SCOPE OF WORK. REFER TO SPECIFICATIONS FOR ADDITIONAL REQUIREMENTS.

Receipt of the addendum shall be acknowledged as part of your submission.

The Board of Management of the Toronto Zoo reserves the right to reject any or all quotations or to accept any quotation, should it deem such action to be in its interests.

If you have any queries regarding this matter, please contact Mr. Peter Vasilopoulos, Supervisor, Purchasing & Supply, at 416-392-5916.

Yours truly,

Peter Vasilopoulos
Supervisor, Purchasing & Supply

I/we hereby acknowledge receipt of this addendum and make allowance in my bid.

Signed (Must be Signing Officer of Firm)

Name of Firm

Date

ADDENDUM

Project Name:	Pavilion Washroom Renovation	Addendum #:	AD-03
Project Number:	1193059	Date:	April 14, 2020
Project Address:	200 Meadowvale Road Toronto, Ontario	Client:	Toronto Zoo

The following information supplements and/or supersedes the bid documents issued for Tender on March, 13, 2020.

This Addendum forms part of the contract documents and is to be read, interpreted, and coordinated with all other parts. The cost of all contained herein is to be included in the contract sum. The following revisions supersede the information contained in the original drawings and specifications issued for the above-named project to the extent referenced and shall become part thereof. Acknowledge receipt of this Addendum by inserting its number and date on the Tender Form. Failure to do so may subject bidder to disqualification.

Subject: Ceiling

Description of Addendum

1. Contractor to refer to attached drawings for modifications to the ceiling.

Issued By



Mark Faulds
Lead Designer

CLIENT:



SUB-CONSULTANTS:



DO NOT SCALE OFF DRAWINGS. CONTRACTOR TO SITE VERIFY ALL DIMENSIONS AND REPORT ANY DISCREPANCIES TO ARCHITECT. DRAWINGS ARE THE PROPERTY OF THE ARCHITECT AND ARE NOT TO BE REPRODUCED AND DISTRIBUTED WITHOUT WRITTEN PERMISSION FROM ARCHITECT. DRAWINGS ARE NOT TO BE USED FOR ANY PURPOSE OTHER THAN THE LATEST ISSUE SHOWN BELOW.

NO.	DESCRIPTION	DATE
01	50% REVIEW	19/09/24
02	TENDER REVIEW	19/10/04
03	TENDER	19/10/29
04	TENDER	20/03/13
05	ADDENDUM #01	20/04/02
06	ADDENDUM #02	20/04/08
07	ADDENDUM #03	20/04/14

TORONTO ZOO
 361A OLD FINCH AVE
 TORONTO, ONTARIO, M1B 5K7
 WASHROOM UPGRADES - AFRICAN PAV.

REFLECTED CEILING PLAN

Project number	2019-06
Date	2019-10-04
Drawn by	M FAULDS
Checked by	J HORVATH

A203

Scale 1 : 25

SUSPENDED POT LIGHT
 HEIGHT: 2600mm

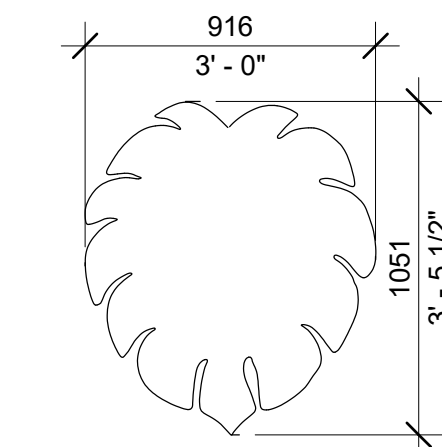

LEAF 1
 HEIGHT: 2650mm

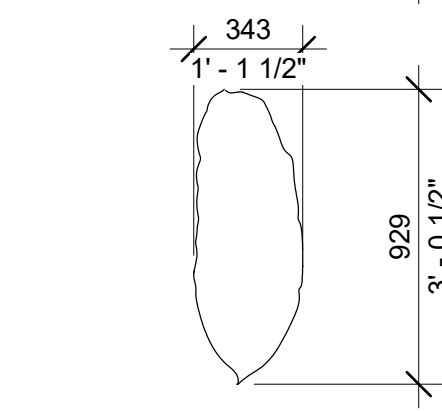

LEAF 2
 HEIGHT: 2600mm

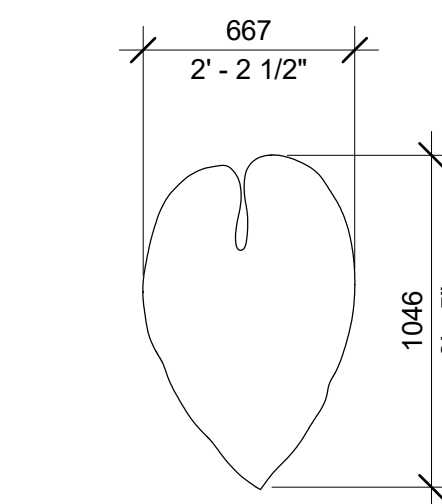

LEAF 3
 HEIGHT: 2700mm

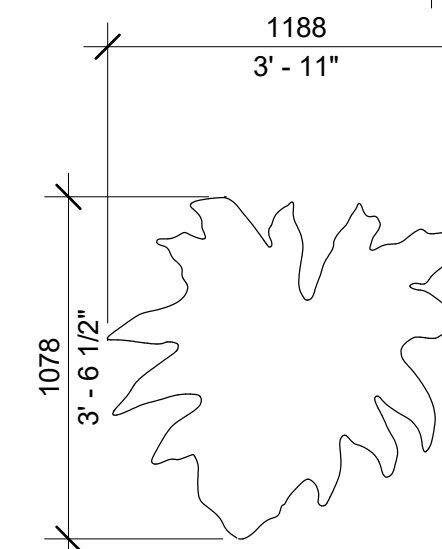

LEAF 4
 HEIGHT: 2750mm

- NOTE:
- LEAVES ARE TO BE MADE OF TRANSLUCENT PLEXIGLASS COLOURED ACRYLIC SHEETS THAT ARE CUT TO THE LEAF PROFILES AS ILLUSTRATED. LEAF TEMPLATE CAN BE PROVIDED AT CONTRACTOR'S REQUEST OR A SIMILAR PROFILE CAN BE SUBMITTED FOR CONSULTANTS REVIEW
 - TRANSPARENT PLEXIGLASS SHEETS TO BE A MINIMUM OF 1/4" (6mm) THICK.
 - COLOUR OF LEAVES TO BE A VARIETY OF GREEN FROM LIGHT GREEN TO DARK GREEN. THREE GREEN COLOURS ARE TO BE SELECTED AND ARE TO BE CUSTOM COLOURED.
 - LEAVES TO BE SUSPENDED FROM CONCRETE CEILING SLAB UTILIZING CABLE SYSTEM SUCH AS THE ORL CABLE DISPLAY SYSTEM OR APPROVED EQUIVALENT
 - HEIGHT OF LEAVES TO RANGE. AS THERE ARE FOUR LEAF PROFILES, EACH PROFILE SHALL BE INSTALLED AT A DIFFERENT HEIGHT RANGING IN 50mm +/- INTERVALS.
 - EXACT PLACEMENT OF LEAVES TO BE REVIEW AND APPROVED WITH THE CONSULTANT PRIOR TO FINAL INSTALL. ALLOW FOR ADJUSTMENTS DUE TO ELECTRICAL AND MECHANICAL PLACEMENTS.
 - ALL CEILINGS, MECHANICAL AND ELECTRICAL CEILING COMPONENTS (I.E. DUCTWORK, CONDUITS, ETC.) ARE TO BE PAINTED THROUGHOUT AND UTILIZE PAINT SPECIFIED IN FINISH SCHEDULE ON A002.
 - COORDINATE INSTALL OF ALL LEAVES WITH CONSULTANT.
 - ENSURE SMOKE DETECTORS ARE NOT COVERED BY LEAVES
 - REFER TO ELECTRICAL DRAWINGS FOR FLOOD LIGHT LOCATIONS. FLOOD LIGHTS TO BE INSTALLED CLOSE TO U/S OF CEILING SLAB.
 - OCCUPANCY SENSORS AND SMOKE DETECTORS ARE TO BE INSTALL CLOSE TO U/S OF CEILING SLAB
 - PULL STATIONS AND LIGHT SWITCHES ARE TO BE INSTALLED 1100mm AFFL, IF PRESENT

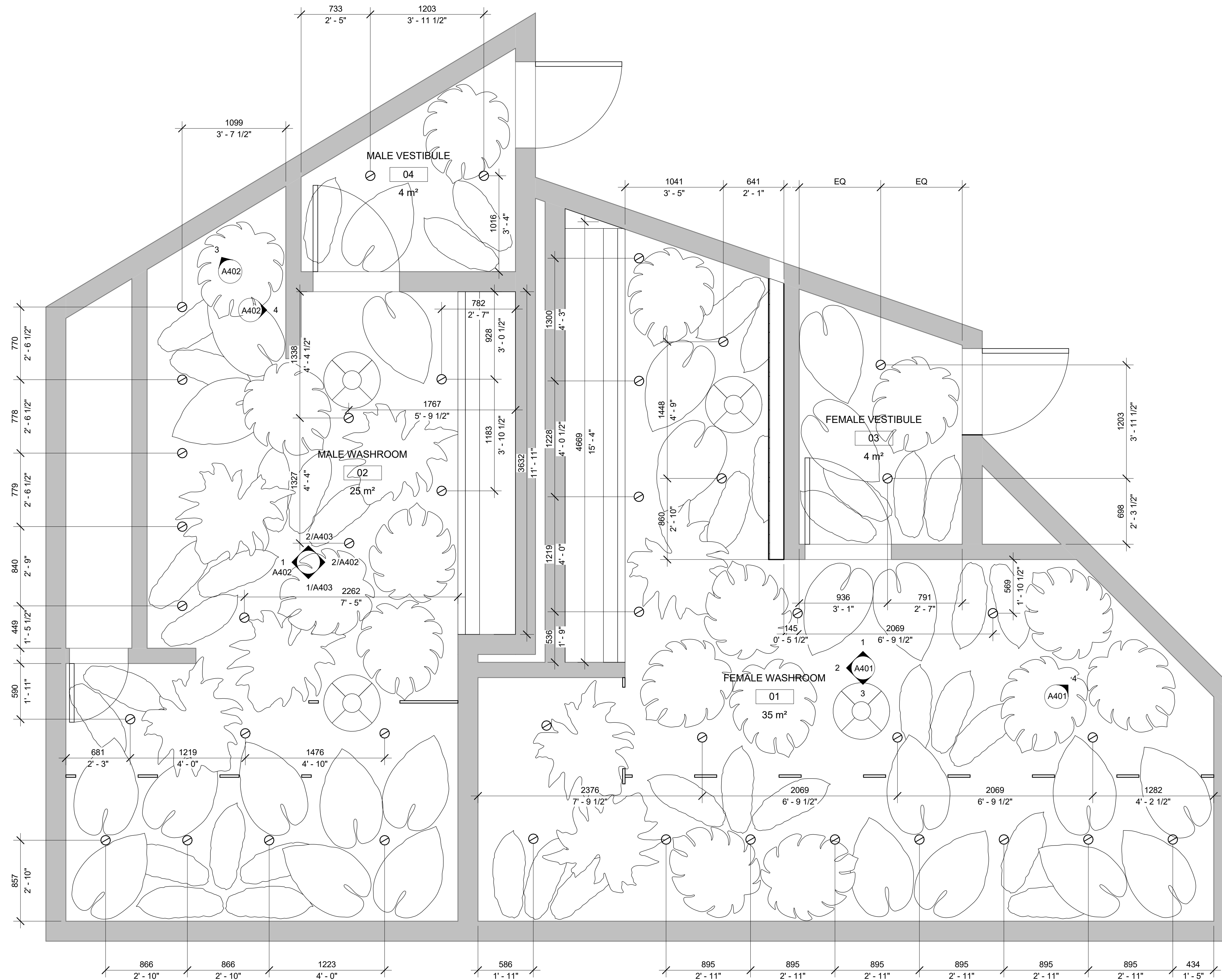

HCC ENGINEERING LIMITED

Design and Technology Services Group

40 Eglinton Avenue East

Suite 600

Toronto, Ontario

M4P 3A2

Tel: (416) 932-2423

Tender Addendum #E-02

Project: **WC Upgrades – African Pavilion
Toronto Zoo
361A Old Finch Ave
Toronto, Ontario**

HCC Engineering Project No.: **19240
BCIN# 28954**

Date: **April 15, 2020**

1. General

1. This tender addendum is an integral part of the Specifications and Drawings and shall form an integral part of the Contract Documents.

2. Drawings

1. Drawing No. E-7.1 (Reissued with Addendum)

End of Tender Addendum #E-02



SUB-CONSULTANTS:



HCC ENGINEERING
 DESIGN AND TECHNOLOGY SERVICES GROUP
 HCC ENGINEERING LIMITED
 40 EGLINTON AVENUE EAST, SUITE 600
 TORONTO, ONTARIO, M4P 3A2
 TEL: (416) 932-2423

DO NOT SCALE OFF DRAWINGS. CONTRACTOR TO SITE VERIFY ALL DIMENSIONS AND REPORT ANY DISCREPANCIES TO ARCHITECT. DRAWINGS ARE THE PROPERTY OF THE ARCHITECT AND ARE NOT TO BE REPRODUCED AND DISTRIBUTED WITHOUT WRITTEN PERMISSION FROM ARCHITECT. DRAWINGS ARE NOT BE USED FOR ANY PURPOSE OTHER THAN THE LATEST ISSUE SHOWN BELOW.

No.	Description	Date
1	ISSUED FOR CLIENT REVIEW	04OCT19
2	ISSUED FOR TENDER	03APR20
Δ	ISSUED FOR ADDENDUM E-02	15APR20

TORONTO ZOO
 361A OLD FINCH AVE
 TORONTO, ONTARIO, M1B 5K7
 WC UPGRADES - AFRICAN PAVILION
**ELECTRICAL SINGLE
 LINE DIAGRAM**
 Project number 19240
 Date SEPTEMBER, 2019
 Drawn by KZ
 Checked by HDC

E-7.1
 Scale NTS

- (N-1) RISER IS DIAGRAMMATIC ONLY. REFER TO FLOOR PLANS FOR DEVICE QUANTITY AND LOCATIONS.
- (N-2) PROVIDE FIRE RATED PLYWOOD BACKBOARDS FOR ALL ELECTRICAL DISTRIBUTION EQUIPMENT PROVIDED AS PART OF THIS CONTRACT AND FOR ALL PREPURCHASED / PREQUALIFIED DISTRIBUTION. PAINT BACKBOARDS WITH FIRE RETARDANT PAINT (COLOUR AS DIRECTED ON SITE BY PROJECT MANAGER). FIRE RATED STAMP MUST BE ON ALL PIECES PROVIDED AND MUST BE VISIBLE WHEN INSTALLED. DO NOT PAINT OVER STAMP.
- (N-3) ALL INDOOR DISTRIBUTION PROVIDED AS PART OF THIS SCOPE OF WORK MUST BE TYPE 2 ENCLOSURE, UNLESS SPECIFICALLY NOTED OTHERWISE. PROVIDE COMPRESSION FITTINGS FOR SERVICES ENTERING DISTRIBUTION.
- (N-4) PROVIDE DEDICATED CORE DRILLED WALL AND FLOOR PENETRATIONS ON EVERY FLOOR. EXACT LOCATION OF ALL CORE DRILLS TO BE DETERMINED BY X-RAY RESULTS. ALL X-RAYS MUST BE REVIEWED AND APPROVED BY LANDLORD PRIOR TO CORE DRILLING.
- (N-5) PROVIDE TEMPORARY POWER AND LIGHTING THROUGHOUT PROJECT TO ACCOMMODATE REQUIREMENTS OF ALL TRADES. REQUIREMENTS INCLUDE PROVIDING EXTENSION CORDS, EXTENSION LIGHTING AND EQUIPMENT REQUIRED FOR THE WORK OF ALL TRADES. ALL COSTS RELATED TO THIS WORK SHALL BE INCLUDED IN THE BASE BID PRICE.
- (N-6) ROUTE ALL CONDUIT SYSTEMS AROUND EXISTING DUCT WORK, BEAMS, NEW DUCT WORK AND PIPING AS REQUIRED TO ACCOMMODATE CONDUIT SYSTEM INSTALLATION. REFER TO MECHANICAL DRAWINGS AND DESIGNER DRAWINGS FOR ADDITIONAL DETAILS.
- (N-7) ALL BREAKERS REQUIRED TO COMPLETE ALL SCOPES OF WORK TO BE NEW. DO NOT REUSE EXISTING BREAKERS.
- (N-8) PROVIDE NEW CIRCUIT BREAKER BUCKET C/W BREAKER INDICATED. PROVIDE REPLACEMENT PARTS, DOOR, MOUNTING HARDWARE, CONN KIT CED6 3.75" H, FILLER PLATES, PRE-FABBED MCC BUS LINKS, ETC., TO ACCOMMODATE INSTALLATION AND FOR MODIFYING EXISTING PANEL BUS. PROVIDE LUGS TO ACCOMMODATE WIRE SIZE INDICATED. PROVIDE THE SERVICE OF SIEMENS FIELD SERVICES GROUP OR EQUIVALENT CSA APPROVED MANUFACTURER OF ELECTRICAL POWER DISTRIBUTION EQUIPMENT TO EXTEND, REWORK, MODIFY AND RECERTIFY EXISTING PANEL BUS AS REQUIRED TO FACILITATE INSTALLATION OF BREAKER BUCKET C/W BREAKER PROVIDED AS PART OF THIS SCOPE OF WORK. REFER TO DETAIL NO. 1 ON DRAWING E-7.1 FOR ADDITIONAL REQUIREMENTS.

- ① EXISTING MOTOR CONTROL CENTER - 120/208V/3PH/4W/SIEMENS MODEL BPG02 MOTOR CONTROL CENTRE (100KA RMS)
- ② EXISTING RECEPTACLE PANEL - 120/208V/3PH/4W/225A MAINS/42CCT/FEDERAL PACIFIC
- ③ RECEPTACLE PANEL - 120/208V/3PH/4W/125A MCB/COPPER BUS/90CCT 20"W/BASIS OF DESIGN SIEMENS P2/100KA RMS SERIES RATED/RECESSED TRIM FACTORY PAINTED CUSTOM COLOUR (MATCH TO PAINT CHIP TO BE PROVIDED BY INTERIOR ARCHITECT DURING CONSTRUCTION)

————— DENOTES NEW PROVIDED BY ELECTRICAL CONTRACTOR
 - - - - - DENOTES EXISTING TO REMAIN
 * * * * * DENOTES EXISTING TO BE REMOVED BY ELECTRICAL CONTRACTOR

ELECTRICAL CONTRACTOR TO PREPARE A PRELIMINARY ZERO FEEDER LENGTH COORDINATION STUDY PRIOR TO ORDERING DISTRIBUTION. SUBMIT TO CONSULTANT FOR REVIEW AND APPROVAL.

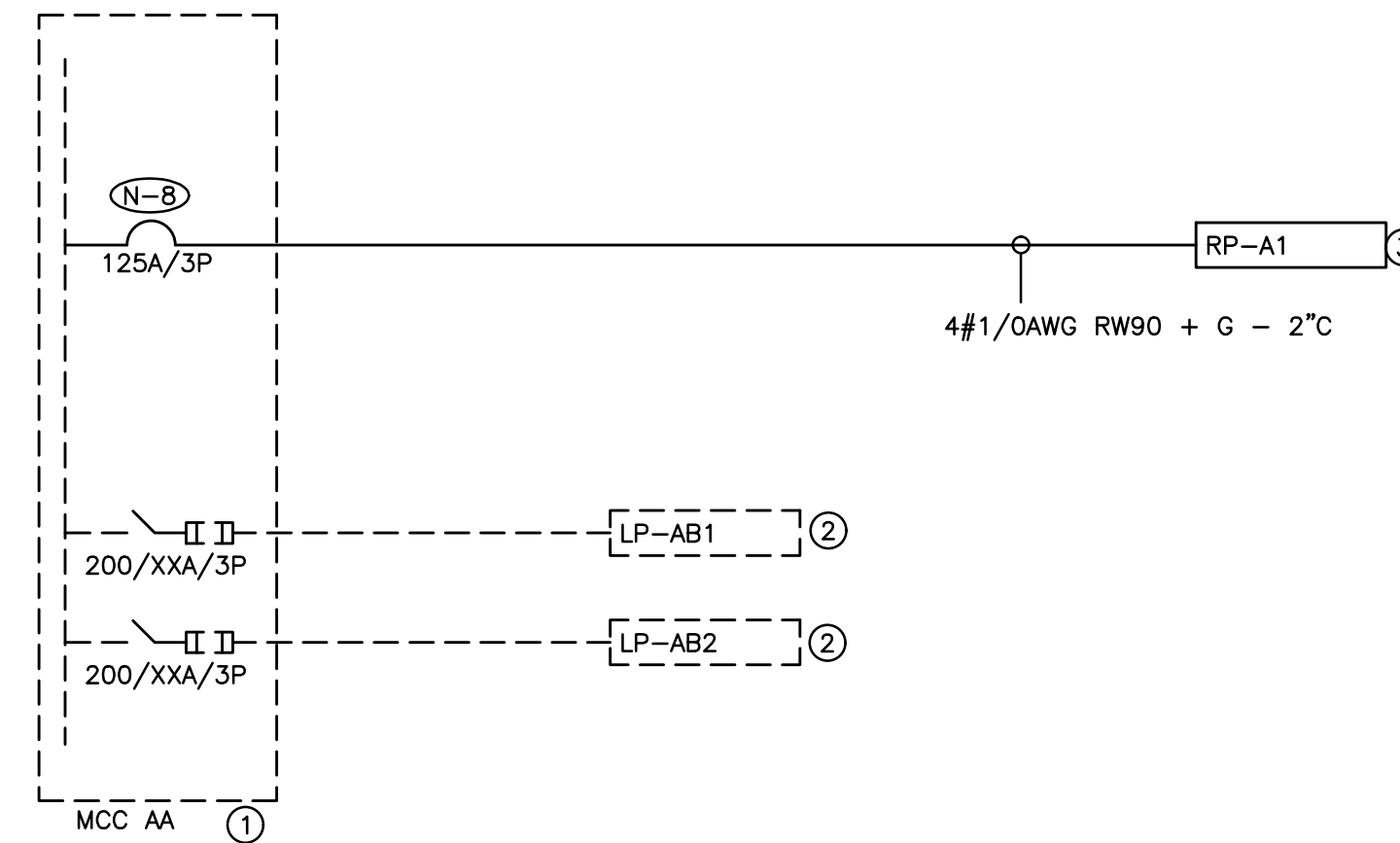

- (N-1) PHOTO ILLUSTRATES EXISTING MOTOR CONTROL CENTER INSTALLATION AND IS INCLUDED FOR REFERENCE PURPOSES ONLY.
- (N-2) FIELD RETROFIT CIRCUIT BREAKER BUCKET C/W BREAKER PROVIDED AS PART OF THIS SCOPE OF WORK INTO EXISTING CUBICLE INDICATED. PROVIDE NEW DOOR, TYPE TO MATCH EXISTING.

1 EXISTING MOTOR CONTROL CENTER 'MCC AA' INSTLLATION PHOTO
 E-7.1 SCALE: NTS